



CHEM-PROOF

SINCE 2002

*POLYPROPYLENE
CENTRIFUGAL PUMP*



CHEM-PROOF

*TOTAL
CORROSIIVE
PUMPING SOLUTIONS...*

SERIES - CPP

DEFINATION

Series **"CPP"** Industrial Centrifugal Plastic Pumps are Designed & Manufactured to Meet The Stringent Requirement for Handling Corrosive Liquids Including Moderate Slurries. The Pump Design Confirms to **IS-5120** Standard , Which Gives Higher Efficiency. All Wetted Parts Coming in Contact With The Liquids Are Injected Moulded, Which Can Withstand in Higher Pressures. The Pump Shaft is Protected From Corrosive Media With Reliable Sealing Arrangement. Our Pump Manufacturing Program Ensure Quality, Reliability & Trouble Free Operation for Long Duration.

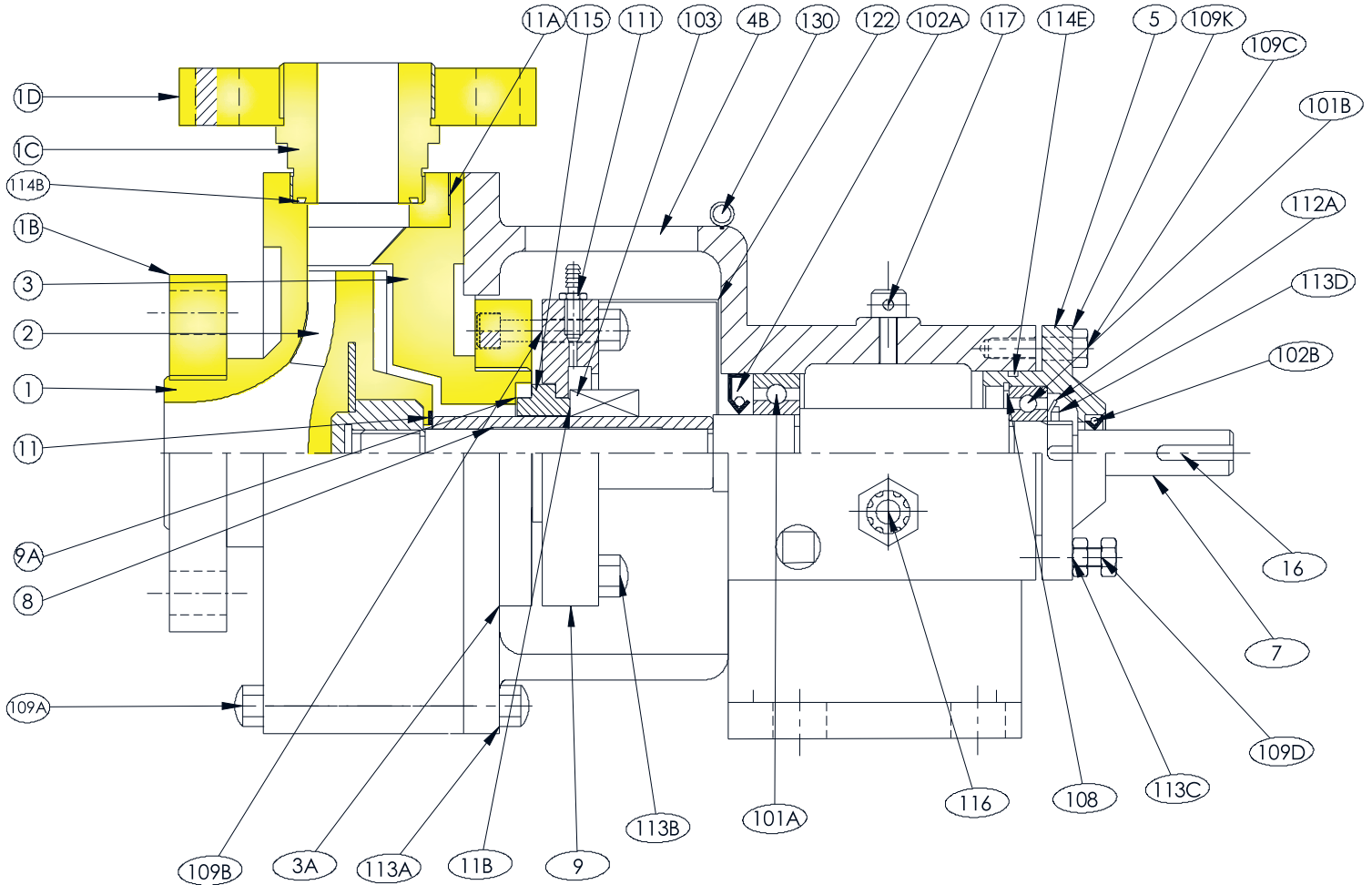

No.	Qty	Part Name	Material	No.	Qty	Part Name	Material	No.	Qty	Part Name	Material
1	1	CASNING	PP/GRP	11B	1	GASKET MATING RING	PTFE	113A	6	NUT WITH GRP	STEEL WITH GRP
1B	1	SUCTION FLANGE	PP/GRP	16	1	KEY	STEEL	113B	4	NUT WITH GRP	STEEL WITH GRP
1C	1	DISCHARGE BRANCH	PP/GRP	17	1	DEFLECTOR	PP	113D	1	LOCK NUT	STEEL
1D	1	DISCHARGE FLANGE	PP/GRP	101A	1	INBOARD BEARING	STEEL	136	1	BERING LOCK NUT	STELL
2	1	IMPELLER	PP/GRP	101B	1	OUTBOARD BEARING	STEEL	114E	1	'O' RING DISCHARGE	VITON
3	1	STUFFING BOX	PP/GRP	102A	1	INBOARD OIL SEAL	NEOPRENE	114E	1	'O' RING	NEOPRENE
3A	1	STUFFING BOX FLANGE	PP	102B	1	OUTBOARD OIL SEAL	NEOPRENE	115	1	MATING RING	CERAMIC
4B	1	BEARING FRAME	CI	103	1	ROTARY	GFT	116	1	OIL VIEWER	ALLUMINUM
5	1	BEARING CUP	CI	108	1	CIRCLIP (INTERNAL)	STEEL	117	1	BREATHER	STEEL
7	1	SHAFT	En8	109A	6	HEX. BOLT	STEEL WITH GRP	130	1	EYE BOLT	STEEL
8	1	SLEEVE	HB/CERAMIC/A-20	109B	4	HEX.. BOLT	STEEL	112	2	SEAL COVER	PP
112	1	SLEEVE SUPPORTER	SS316	109C	3	HEX.. BOLT	STEEL				
9	1	GLAND	BAKELITE	109D	3	HEX.. BOLT	STEEL				
9A	1	CFT BUSH	CFT	113C	1	HEX.. BOLT	STEEL				
11	1	IMPELLER GASKET	PTFE	111	2	NIPPLE	PP				
11A	1	GASKET CASING	PTFE	112A	1	LOCKING WASHER	STEEL				

FAMILY CURVES

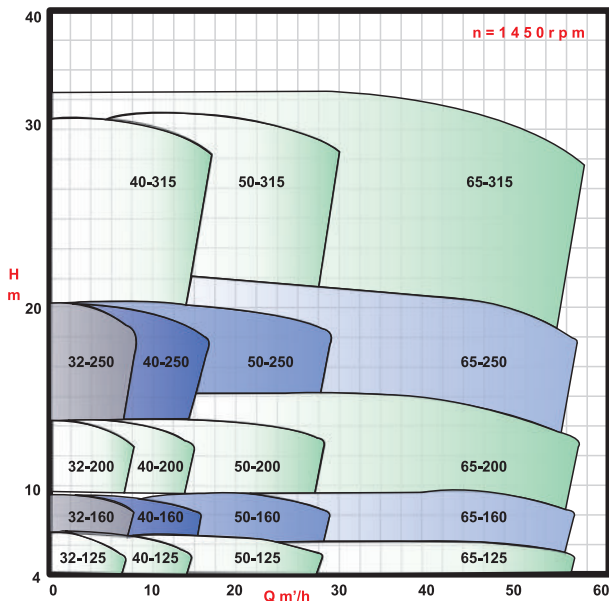

DESIGN CONSTRUCTION DETAILS :-

Casing, stuffing box and impeller are offered in Various Material

- Polypropylene*
- UHMW
- Hdpe
- Glass-fibre Reinforced Polypropylene
- PTFE

* Offered as standard

IMPELLER :-

Solidly moulded, semi-open impeller with metal insert ensures high strength and durability. The impeller is dynamically balanced as per ISO 1940 to achieve minimum vibration and extended bearing life.

SHAFT :-

As a standard shaft is offered EN-8 Material. Different materials can be offered on request.

SHAFT SLEEVE :-

Sleeve is protecting the shaft from the attack of corrosive media and can be offered in various materials after confirming chemical compatibility.

- Ceramic (99.5% Alumina Oxide)*
- Silicon Carbide
- Monel
- Alloy-20 (CN7M)
- Hastelloy-B
- Hastelloy-C
- Titanium

* Offered as standard

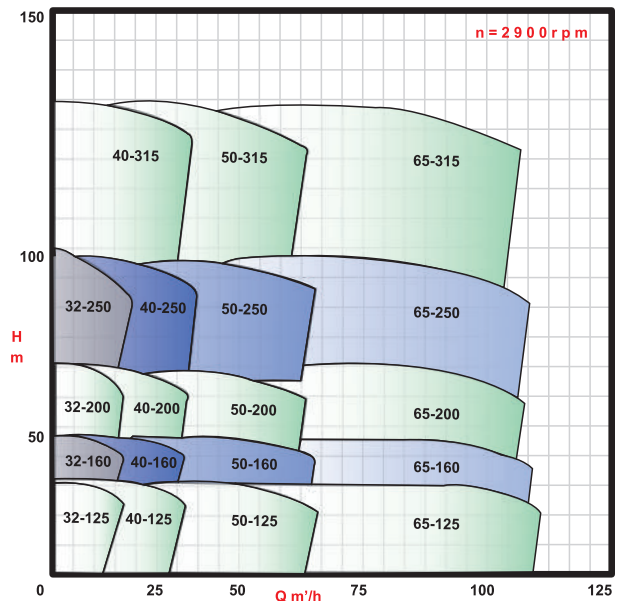

MECHANICAL SEAL:-

As single externally mounted PTFE bellows Mechanical Seal with various face combination is offered after confirming chemical compatibility.

- GFT v/s CERAMIC *
- GFT v/s SILICON
- CARBON v/s CERAMIC
- CARBON v/s SILICON
- SILICON v/s SILICON

* Offered as standard

SEALING :-

'O' Ring and Gaskets Sealing are provided in the joints to ensure better sealing even at high pressure.

ACCESSORIES

PRIMING CHAMBER :-

This is specially used for negative suction. It is effective in handling liquids with slurry or particles, as it does not get clogged as easily as the foot valve.

TROLLEY :-

A specially designed, vibration free trolley keeps the pump mobile, whenever required. Further the trolley can also be provided with FRV coating on the parts exposed to chemical drip.

MFG UNIT :-



SINCE 2002

CHEM-PROOF PUMPS (I) PVT. LTD

THE PERFECT PUMPING TECHNOLOGY

G-1602 Raj Estate, kashimira Road, Mira road (east), Mumbai 401 103, INDIA.

Phone: +91 9175467779 , 9004407779 , 9004179777

Website: www.chemproofpumps.com E-mail: sales@chemproofpumps.com / chemproof2021@gmail.com

AUTHORISED DEALER



We reserve the right to change specification without notice.